

File Name: C:\DMS\Revit_Projects\17915213.00-Electrical-RT15_saad.mahmoud.rvt
 Date: 09/20/15 3:50:22 PM

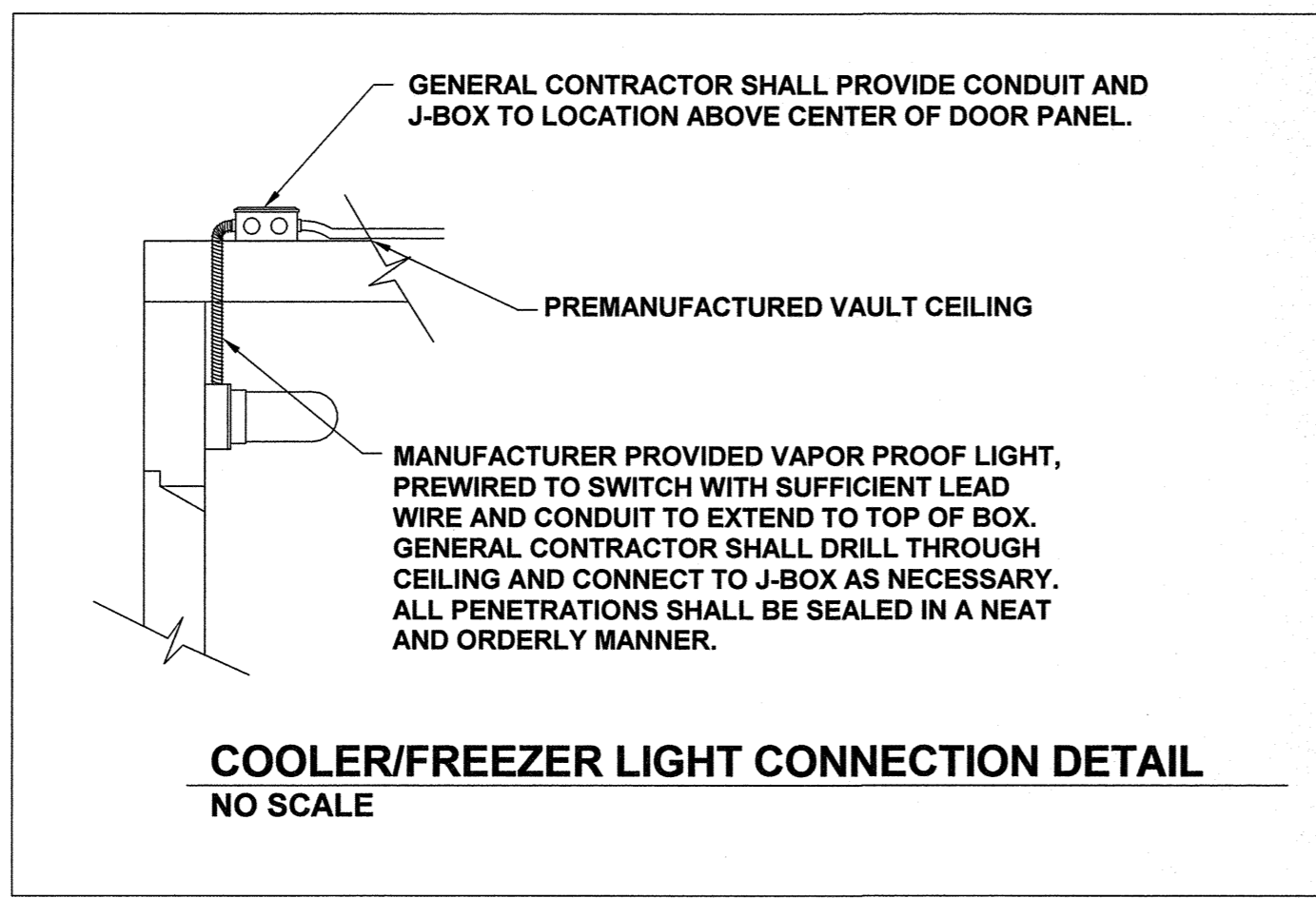

- ELECTRICAL ROUGH-IN NOTES FOR WALK-IN COOLER/FREEZER:**
- A. ELECTRICIAN TO SET DISCONNECTS, ONE PER CONDENSING UNIT.
 - B. ELECTRICIAN TO PULL WIRES TO CONDENSERS, 208V-60-3PH., TO PANEL AS INDICATED ON PLANS.
 - C. ELECTRICIAN TO PULL WIRES TO EVAPORATORS, 208V-60-1PH., TO PANEL AS INDICATED ON PLANS.
 - D. ELECTRICIAN TO RUN CONTROL WIRING BETWEEN CONDENSER & EVAPORATOR, 2 PR. @ 14 GA.
 - E. LIGHT FIXTURES SUPPLIED BY WALK-IN MFG. & INSTALLED BY ELECTRICAL.
 - F. HEAT STRIP FOR DOOR WIRED TO SAME CIRCUIT AS WALK-IN LIGHTS, BY ELECTRICAL.
 - G. ELECTRICIAN TO FURNISH AND INSTALL SPIRAL WRAP HEATER TAPE AROUND DRAIN LINE INSIDE OF WALK-IN FREEZER.

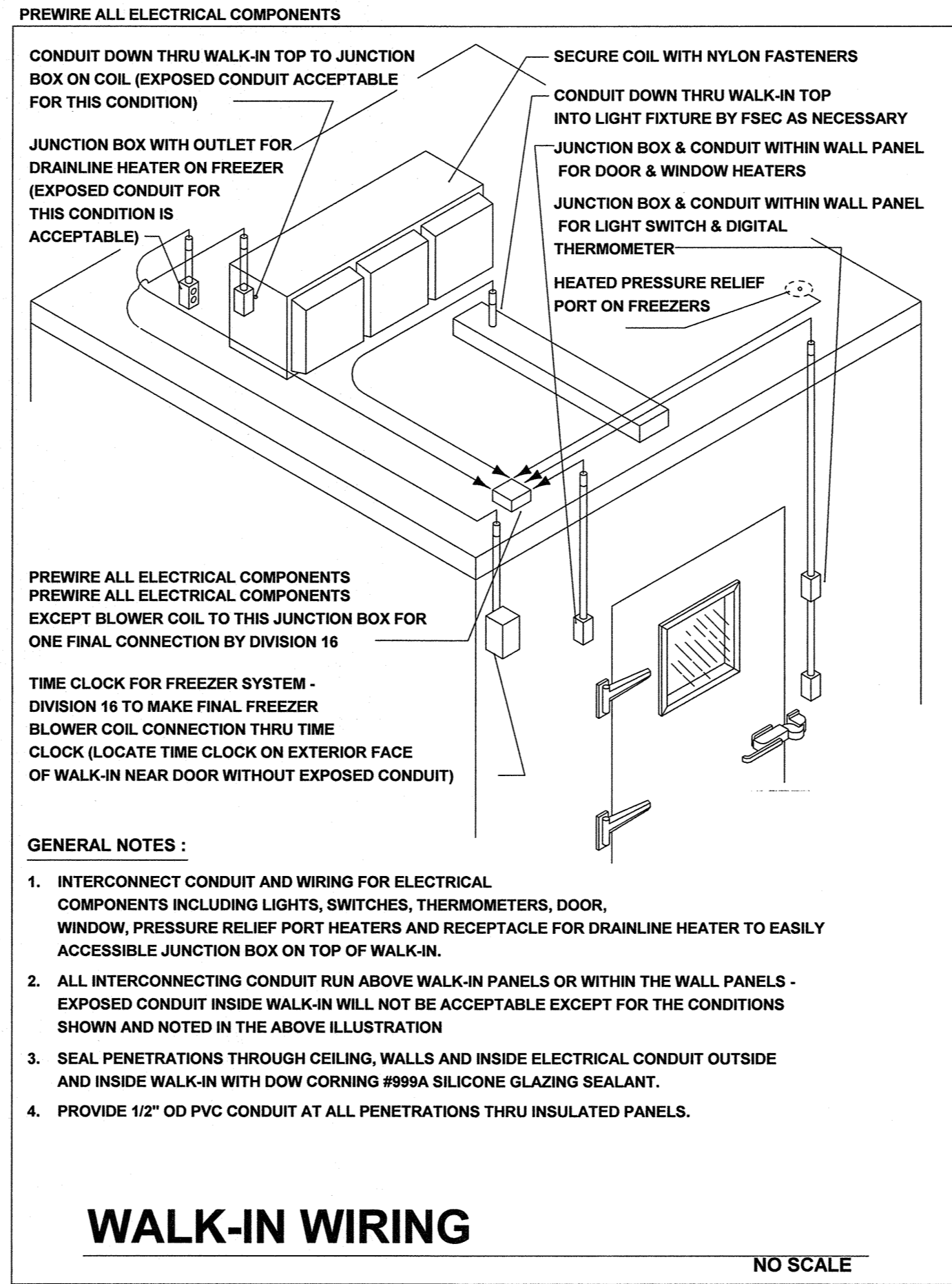

NOTE TO HEALTH DEPT. PLAN CHECKER

LIGHTING LEVEL IN KITCHEN:
 (1) ALL WORKING SURFACE: MORE THAN 50 FOOT-CANDLES PROVIDED.
 (2) ALL OTHER SURFACES AND EQUIPMENT IN FOOD PREPARATION, UTENSIL-WASHING, AND HAND-WASHING AREAS, AND IN TOILET ROOMS: AT LEAST 30 FOOT-CANDLES PROVIDED.
 (3) AT LEAST 20 FOOT-CANDLES AT A DISTANCE OF 30 INCHES FROM THE FLOOR IS PROVIDED IN ALL OTHER AREAS.

LIGHTING FIXTURES IN KITCHEN:
 PROTECTIVE SHIELDING FOR ALL FIXTURES: PROVIDE PROTECTIVE SHIELDING FOR ALL LIGHTING FIXTURES LOCATED OVER FOOD STORAGE, PREPARATION, SERVICE, AND DISPLAY FACILITIES AND FACILITIES WHERE UTENSILS AND EQUIPMENT ARE CLEANED AND STORED.

WALK-IN COOLER & FREEZER
 (1) SEAL ALL CONDUIT PENETRATION INTO WALK-IN COOLER & FREEZER WITH APPROVED MATERIAL PER N.E.C. 300.7.A.

ALL 15-AMP & 20-AMP RECEPTACLES IN KITCHEN SHALL BE GFCI TYPE

GENERAL KITCHEN ELECTRICAL NOTES

THE FOLLOWING WORK IS TO BE PERFORMED BY THE ELECTRICAL CONTRACTOR:

- REFER TO ELECTRICAL EQUIPMENT SCHEDULE FOR CONNECTION REQUIREMENTS OF ALL ELECTRICAL EQUIPMENT.
- ROUGHING-IN AND FINAL CONNECTIONS OF ELECTRICAL SYSTEMS TO FOOD SERVICE EQUIPMENT.
- COMMUNICATION SYSTEMS, CLOCKS AND STAFF TIME CLOCKS IN FOOD SERVICE AREA.
- CONDUIT AND WIRING FROM DISPOSER SWITCH TO TIME DELAY, MAGNETIC STARTER, MOTOR AND SOLENOID VALVES: ALL BELOW COUNTER TOP.
- WALL SWITCH FOR LIGHT FIXTURES IN EXHAUST HOODS.
- WALL SWITCH FOR FAN MOTOR FOR EXHAUST HOOD'S SYSTEM.
- WIRING TO AND INSTALLATION OF ACCESSORIES (IF ANY) WHICH ARE FURNISHED STANDARD WITH FOODSERVICE EQUIPMENT.
- EMERGENCY LIGHTING AND/OR POWER SYSTEMS.
- ALL DISCONNECT SWITCHES AS REQUIRED. (NEMA 4, WATERPROOF SUGGESTED).
- SPECIAL NOTE: ANSUL FIRE SUPPRESSION SYSTEM IS TO BE CONNECTED TO CORRESPONDING SHUNT TRIP BREAKERS FOR SHUT DOWN OF COOKING EQUIPMENT BELOW VENTILATOR DURING FIRE. - IN ADDITION, THE SUPPRESSION SYSTEM SHALL BE REQUIRED TO BE INTERCONNECTED WITH MECHANICAL GAS SHUT OFF DURING FIRE.
- *** DIVISION 16 TO PROVIDE "EMPTY CONDUIT FROM OCTAGONAL JUNCTION BOX IN WALL AT 54" AFF UP THRU WALL TO 6" ABOVE CEILING AND EXIT WALL - FOR FIRE SYSTEM REMOTE PULL.

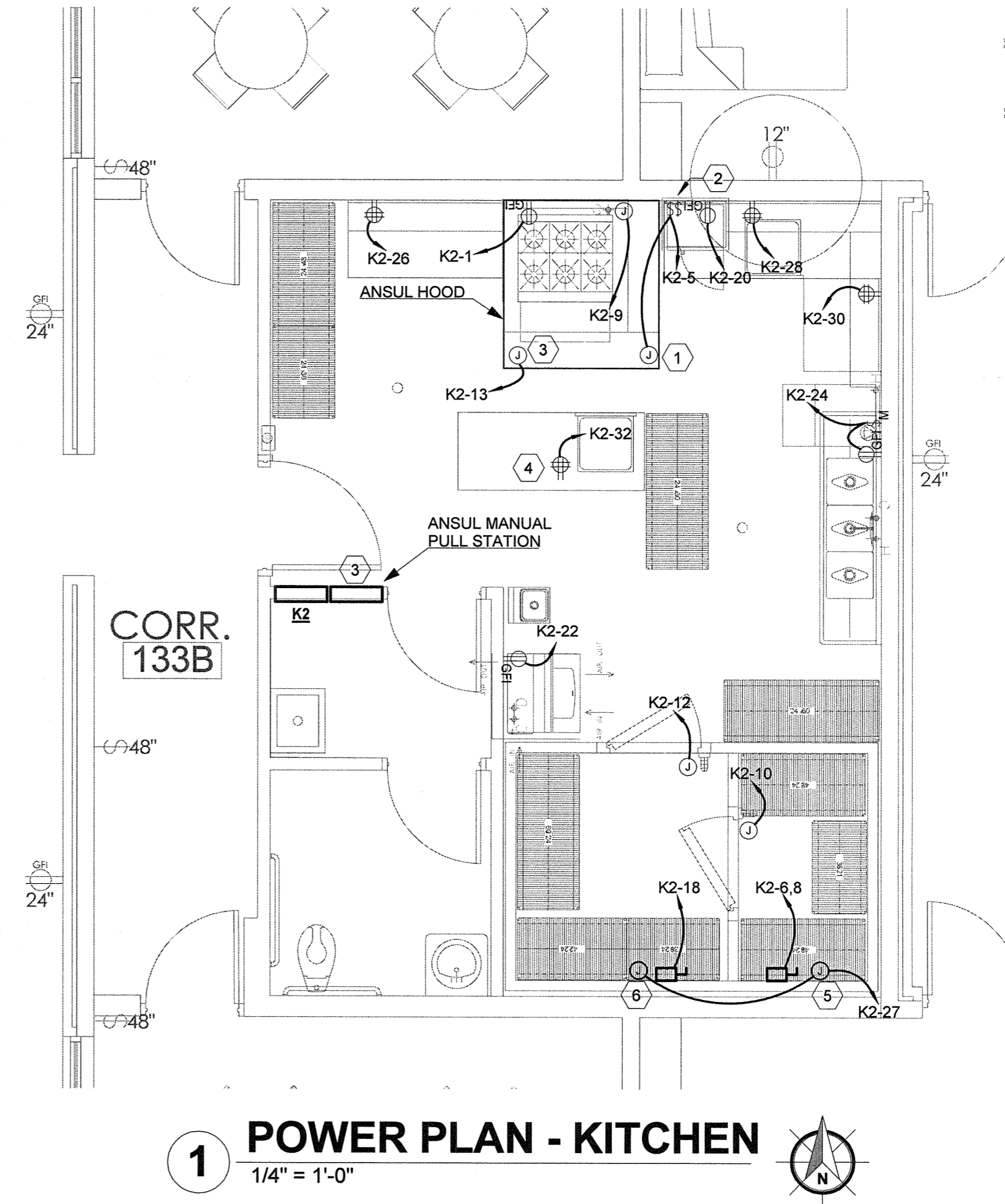

1 POWER PLAN - KITCHEN
1/4" = 1'-0"

- KEYED NOTES**
- CONTRACTOR SHALL FIELD COORDINATE AND INSTALL SWITCH FOR HOOD LIGHT FIXTURES WITH OWNER/ARCHITECT.
 - CONTRACTOR SHALL FIELD COORDINATE AND INSTALL A TOGGLE SWITCH TO OPERATE HOOD EXHAUST FANS. MAF-2 & KEF-2 SHALL BE INTERLOCKED.
 - CONTRACTOR SHALL FIELD COORDINATE ANSUL CONTROL SYSTEM AND MANUAL PULL STATION LOCATION WITH OWNER/ARCHITECT.
 - ALL RECEPTACLES SHALL BE GFI TYPE IN THIS AREA.
 - PROVIDE POWER FOR HEAT TRACE (GFI PER NEC 427.22) ON CONDENSATE DRAIN PIPING FROM WITHIN WALK-IN FREEZER UNIT TO FLOOR DRAIN AT THIS LOCATION. REFER TO PLUMBING DRAWINGS TO FOR EXACT AND COMPLETE WALK-IN FREEZER CONDENSATE PIPING ROUTING. FIELD VERIFY EXACT LOCATION (AND ANY NECESSARY ADDITIONAL LOCATIONS) WITH TENANT/ARCHITECT AND KITCHEN CONSULTANT PRIOR TO ROUGH-IN AND INSTALLATION.
 - PROVIDE POWER FOR HEAT TRACE (GFI PER NEC 427.22) ON CONDENSATE DRAIN PIPING FROM WITHIN WALK-IN REFRIGERATOR UNIT TO FLOOR DRAIN AT THIS LOCATION. REFER TO PLUMBING DRAWINGS TO FOR EXACT AND COMPLETE WALK-IN REFRIGERATOR CONDENSATE PIPING ROUTING. FIELD VERIFY EXACT LOCATION (AND ANY NECESSARY ADDITIONAL LOCATIONS) WITH TENANT/ARCHITECT AND KITCHEN CONSULTANT PRIOR TO ROUGH-IN AND INSTALLATION.

OPTIMUM CARE
SUGAR LAND, TEXAS

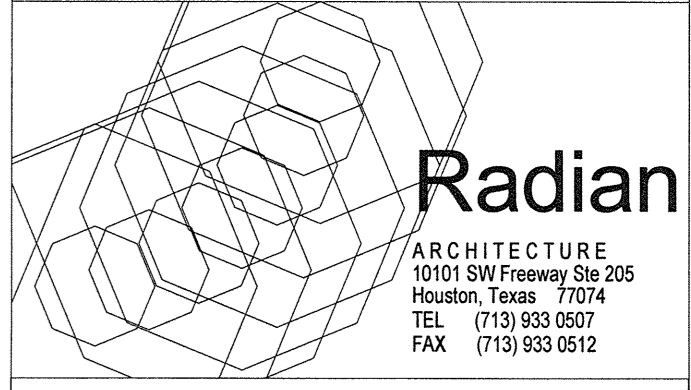

Revision Schedule		
#	Date	Description
3	09-04-15	PERMIT REVISIONS



KCI
ENGINEERS
PLANNERS
SCIENTISTS
CONSTRUCTION MANAGERS
801 TRAVIS, SUITE 2000
HOUSTON, TX 77002
TECHNOLOGIES Ph: 713-237-9800 | Fax: 713-237-9801
Texas Registered Engineering Firm F-10573

Project No.
ELECTRICAL PLAN - KITCHEN

Sheet No.
E1.05